

212 King St. W

Madeleine Nicholls
VICE PRESIDENT, RETAIL

mnicholls@dream.ca | 416.365.2351

David Scorniaenchi
SENIOR MANAGER, RETAIL

dscorniaenchi@dream.ca | 416.365.2374

Dine in the Entertainment District

Located on the northwest corner of King and Simcoe, this 6-storey architectural and historical beauty is situated in Toronto's bustling Entertainment District within walking distance of Roy Thomson Hall, the PATH system, numerous restaurants, and the financial core. It is an ideal restaurant or retail location in the heart of the Entertainment District.

212 King St. W

Overview ▾

- ✓ Historic building
- ✓ Restaurant opportunity
- ✓ Steps from theatres

Details ▾

AVAILABLE **7,687 SF**
ADDITIONAL RENT **\$22.53 (est. 2018)**



KING STREET W & SIMCOE STREET

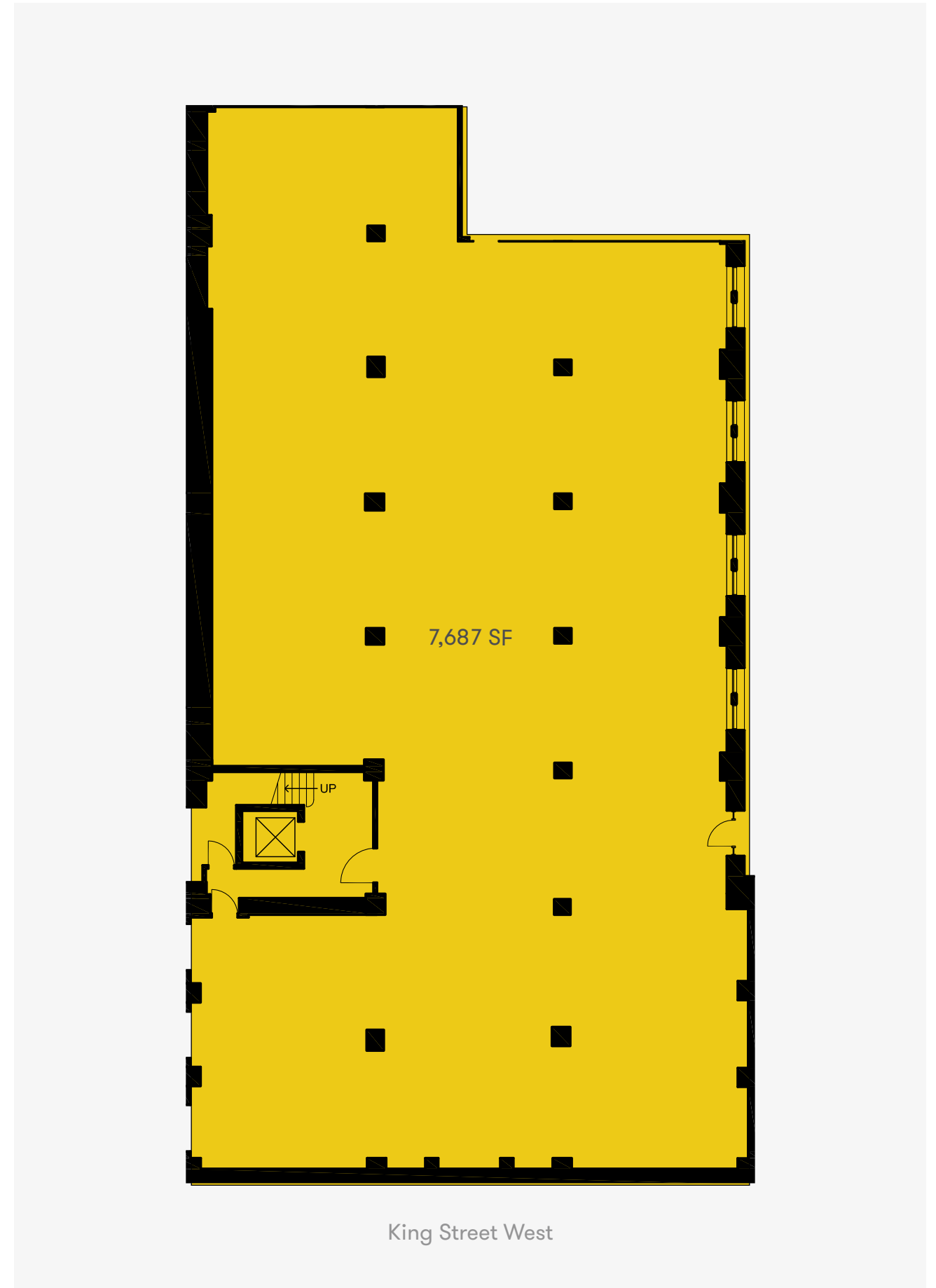

King Street West