

# 630 Queen St. E

**Madeleine Nicholls**  
VICE PRESIDENT, RETAIL

[mnicholls@dream.ca](mailto:mnicholls@dream.ca) | 416.365.2351

**David Scorniaenchi**  
SENIOR MANAGER, RETAIL

[dscorniaenchi@dream.ca](mailto:dscorniaenchi@dream.ca) | 416.365.2374

## High Growth Potential in West Don Lands

Located at the corner of Queen Street East and Carroll Street. Newly developed retail and office space that features high ceilings and great access to Toronto's east end. The Canary District, and Leslieville to the East. Excellent visibility directly on King St.

# 630 Queen St. E

Overview ▾

- ✓ Great corner exposure
- ✓ Retail or office availability

Details ▾

AVAILABLE	<b>4,028 SF</b> (Available Q3 2019)
ADDITIONAL RENT	<b>\$15.00 / SF (est.)</b>
RETAIL OPPORTUNITIES	<b>Unit 100: 4,028 SF</b> <b>Unit 102: 2,719 SF</b> <b>Unit 103: 1,725 SF</b>



QUEEN STREET E & DAVIES AVE

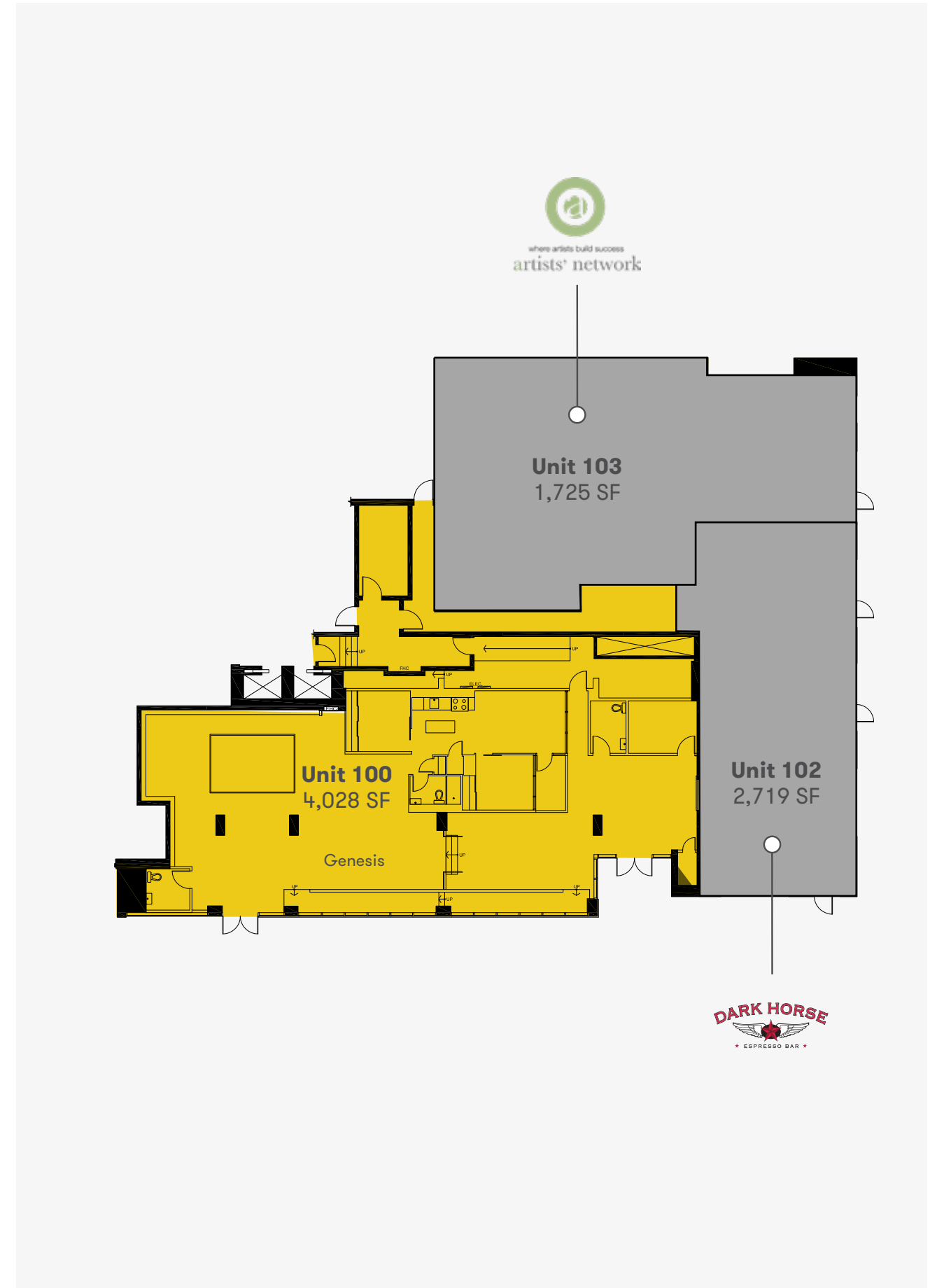

Available Leased