

# 655 Bay St.

**Madeleine Nicholls**  
VICE PRESIDENT, RETAIL

[mnicholls@dream.ca](mailto:mnicholls@dream.ca) | 416.365.2351

**David Scorniaenchi**  
SENIOR MANAGER, RETAIL

[dscorniaenchi@dream.ca](mailto:dscorniaenchi@dream.ca) | 416.365.2374

## A gem on Elm

Situated minutes from the financial core with frontage on Toronto's popular and unique Elm street, 655 Bay Street offers the perfect location for any retail business use. Close proximity to Yonge-Dundas Square, The Eaton Centre and city core puts your business in the midst of downtown action while providing customers and clients with fast, easy access to your retail location.

# 655 Bay Street

Overview ▾

- ✓ Government-occupied building
- ✓ Prime downtown north opportunity
- ✓ Close proximity to Yonge-Dundas Square

Details ▾

TOTAL ADDITIONAL RENT	<b>\$31.66/ SF</b>
BUILDING SIZE	<b>308,431 SF</b>
YEAR BUILT	<b>1990</b>
RETAIL OPPORTUNITIES	<b>Ste 13 1,172 SF</b> <b>Ste 6C 663 SF</b>



📍 BAY STREET & ELM STREET

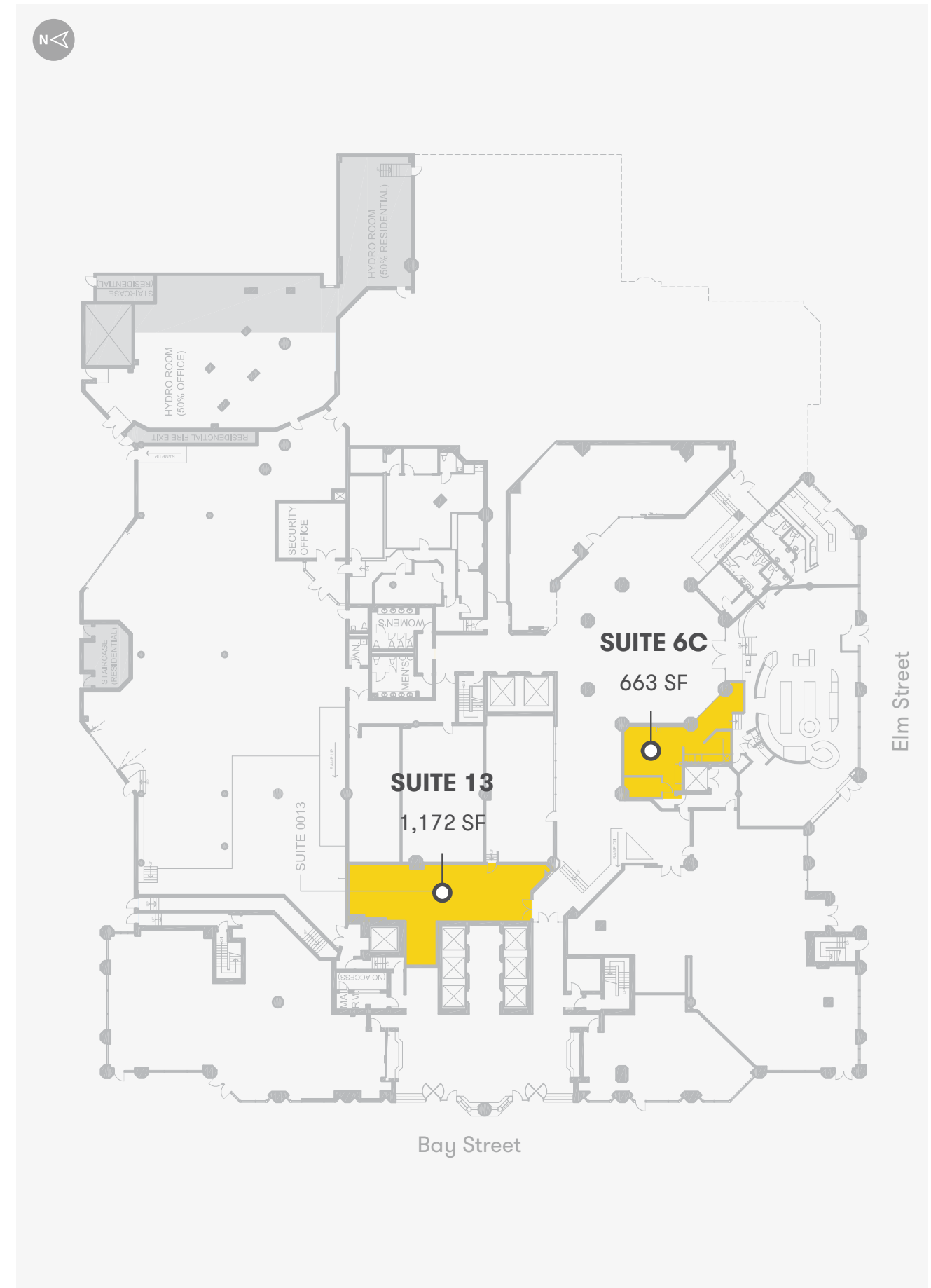

Available